

Large Studio

444 sq. ft.



CHARLES WEST

Manulife Centre

Lowrise, South Facing

Bright and spacious, with hardwood floors and white kitchen cabinets, our unfurnished apartments on floors 3 to 29 are waiting for you to add the personal touches of home. These apartments have utilities and cable included, plus you'll have access to many of our great amenities including the urban garden, party room and club room.

All dimensions are approximate.

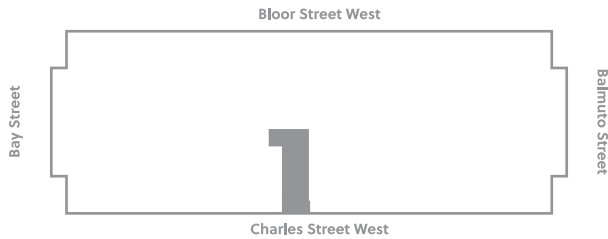
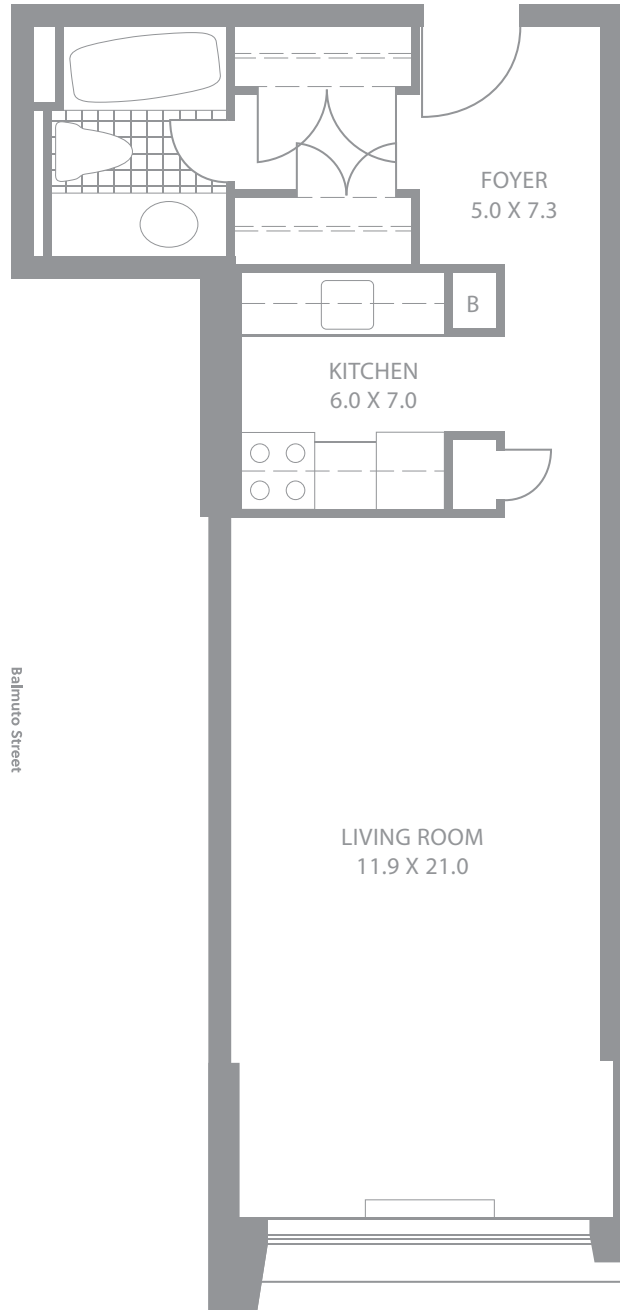

RENTAL INFORMATION

Stella Gomes or Michael Gula
P: 416 961 4998 F: 416 923 7637
E: livemanulifecentre@manulife.com

TENANT SERVICES, MAINTENANCE, CONCIERGE OR PROPERTY MANAGEMENT

P: 416 961 4998 F: 416 923 7637

44Charles.com



Large Studio

471 sq. ft.



CHARLES WEST

Manulife Centre

Lowrise, North Facing

Bright and spacious, with hardwood floors and white kitchen cabinets, our unfurnished apartments on floors 3 to 29 are waiting for you to add the personal touches of home. These apartments have utilities and cable included, plus you'll have access to many of our great amenities including the urban garden, party room and club room.

All dimensions are approximate.

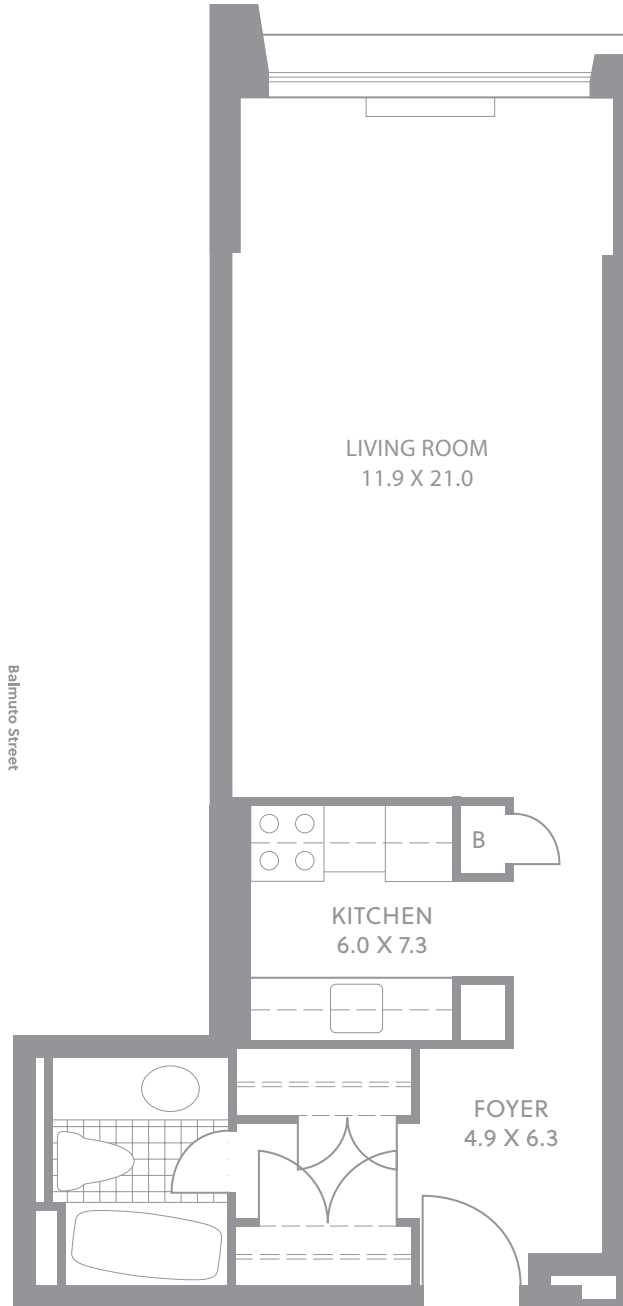

RENTAL INFORMATION
Stella Gomes or Michael Gula
P: 416 961 4998 F: 416 923 7637
E: livemanulifecentre@manulife.com

**TENANT SERVICES, MAINTENANCE,
CONCIERGE OR PROPERTY MANAGEMENT**
P: 416 961 4998 F: 416 923 7637

44Charles.com



Large Studio

471 sq. ft.

Lowrise, North Facing

Bright and spacious, with hardwood floors and white kitchen cabinets, our unfurnished apartments on floors 3 to 29 are waiting for you to add the personal touches of home. These apartments have utilities and cable included, plus you'll have access to many of our great amenities including the urban garden, party room and club room.

All dimensions are approximate.

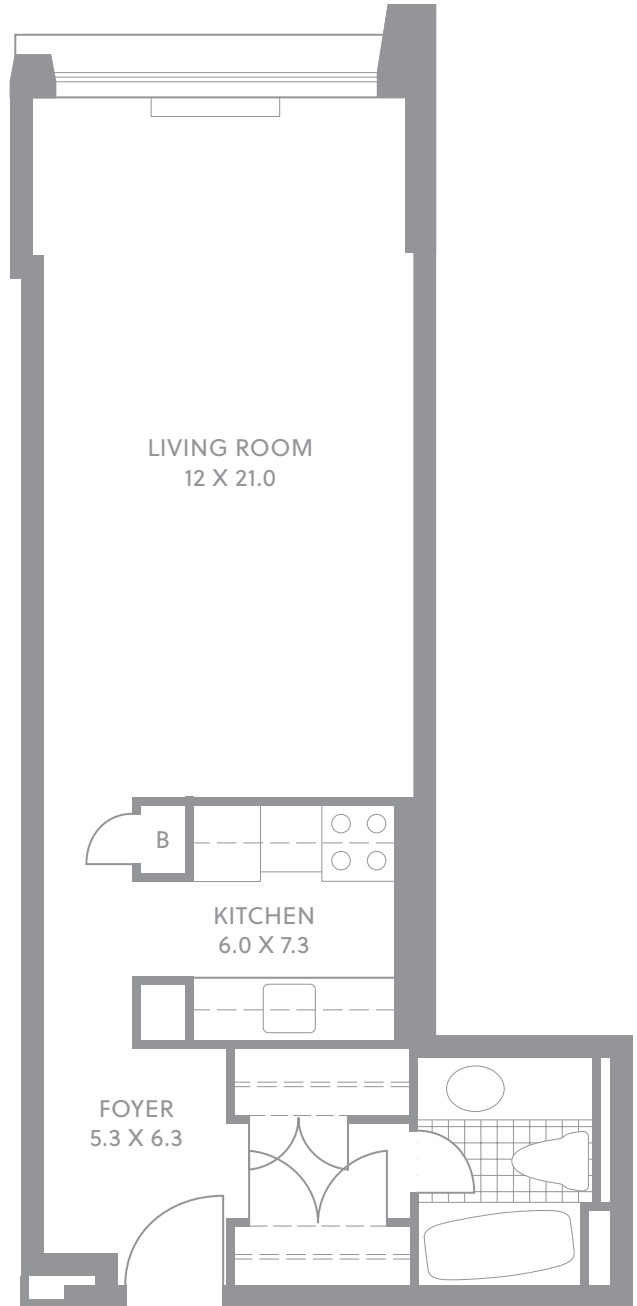
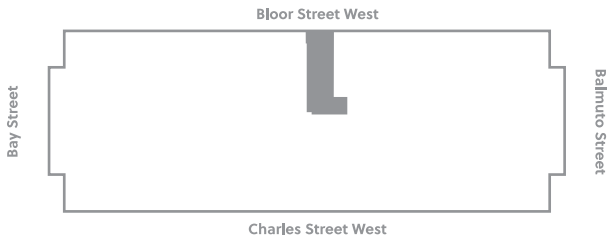

RENTAL INFORMATION

Stella Gomes or Michael Gula
P: 416 961 4998 F: 416 923 7637
E: livemanulifecentre@manulife.com

TENANT SERVICES, MAINTENANCE, CONCIERGE OR PROPERTY MANAGEMENT

P: 416 961 4998 F: 416 923 7637